

WOOD

- MKS Wood P: 12,7 Serrated
- MKS Wood P: 25,4 LOG
- MKS Wood P: 80

As Makelsan Chain we provide quality chain production for all transportation processes such as round timber transportation and saw lanes and wooden transportation, chip transportation, processing in wood industry. During round timber transport our chains are used in a variety of sub-processes. Drive chains and conveyor chains run on the round conveyor, on the root reducer, on the cover saw, on the sorting line, on the block conveying line and during the billet turn.

Our products can be used in almost all woodworking and related sectors;

- › Paper and cellulose industry › Chipboard industry › Furniture industry
- › Pasted lamine wood industry › Wooden polish machines.





MKS Wood P: 12,7 Serrated

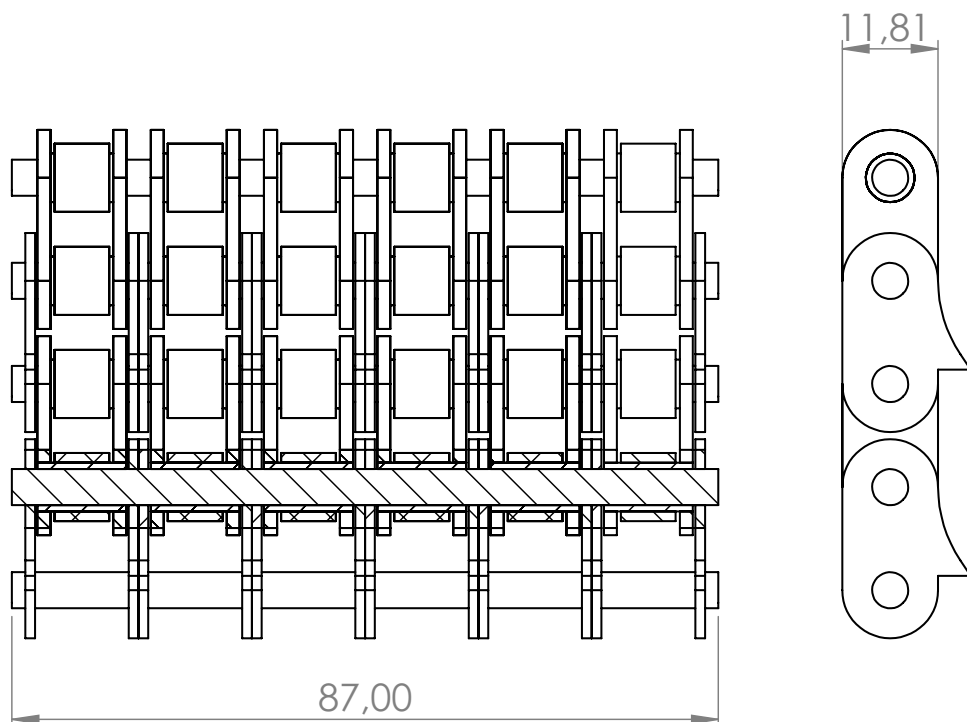

MKS Wood P: 80

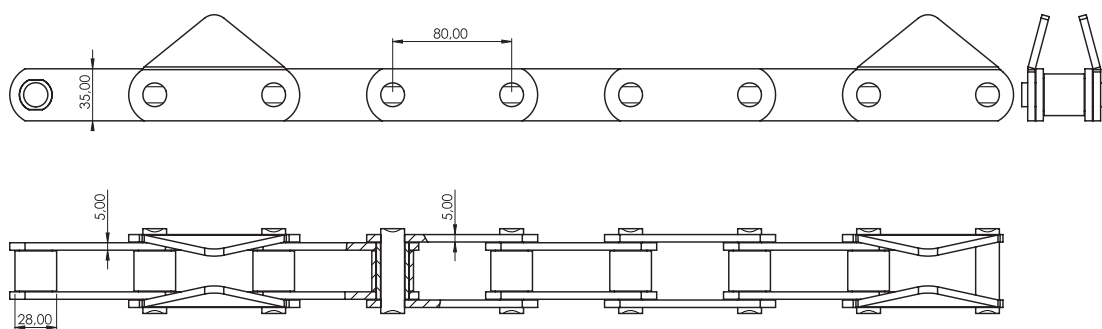

Production based on a given sample or a technical drawing.

MKS Wood P: 25,4 LOG

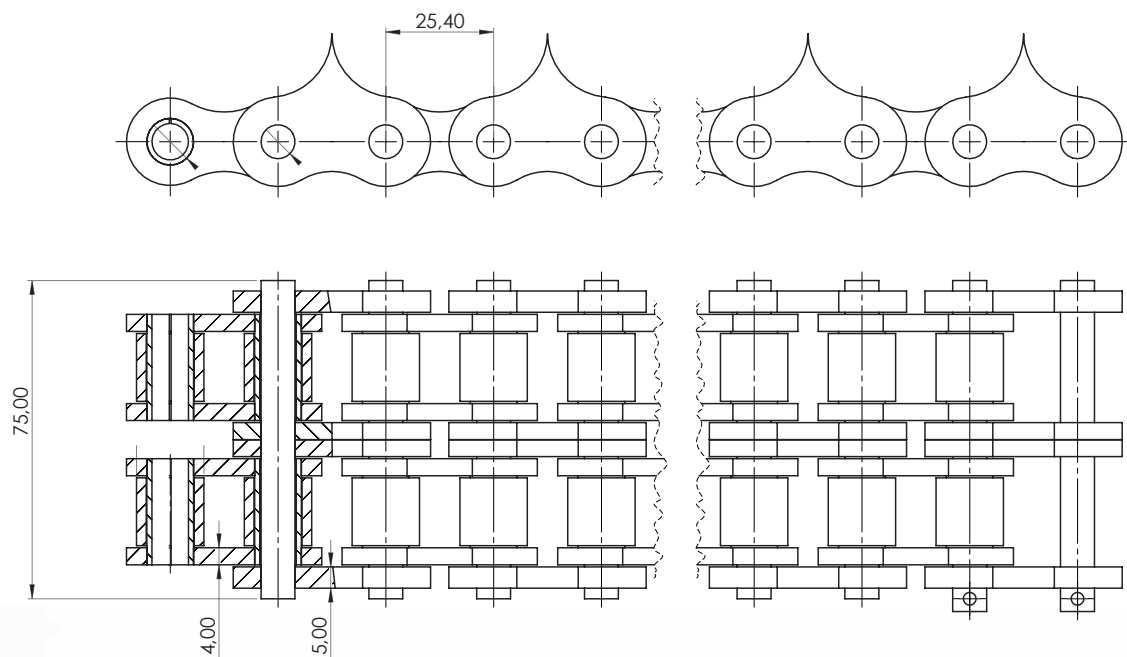

Production based on a given sample or a technical drawing.